

Retract-A-Gate® 72 User's Guide by The Creative Frontier, Inc.

A. Parts: 1 Retract-A-Gate, 4 wall brackets, 8 wall bracket screws, 9 washers (includes 1 extra)

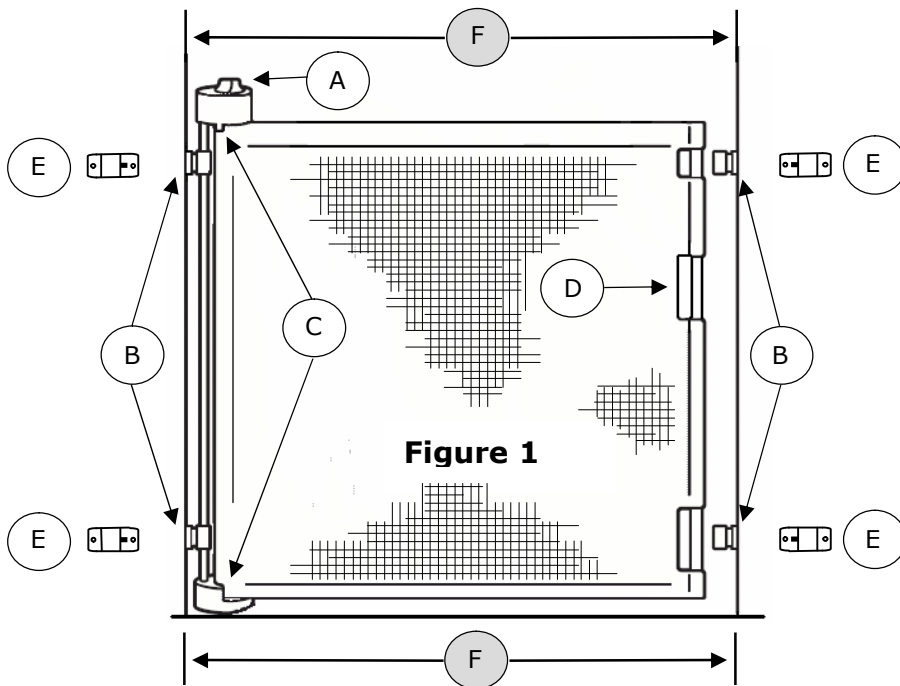

- (A) – Knob/Lock
- (B) – Brackets
- (C) – Fabric Stops
- (D) – Handle Slot
- (E) – Alternate bracket locations
- (F) – Keep top and bottom brackets equal distance apart (**72" maximum opening**)

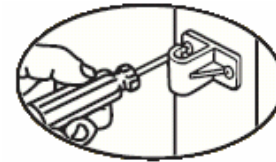

Figure 2



Figure 3

⚠ WARNING: ▶To prevent serious injury or death, securely install gate and use according to manufacturer's instructions ▶This product will not necessarily prevent all accidents. Never leave child unattended ▶Use only with the gate securely in the locked position ▶Never use with a child able to climb over or dislodge the gate ▶For use with children 6 months through 24 months

B. How to Install (before attempting installation, read this entire User's Guide)

Retract-A-Gate is designed to attach to **either** side of a doorway. The gate may be mounted directly in the door jam or around the side of a doorway on the wall (**Fig. 1-E**).

To install at the top of a staircase, the gate must be mounted at the highest floor level (and a minimum of 6 inches back from the edge of the top step). The bottom level of the staircase is generally the safest installation.

1. Installing the brackets

Tools needed: #2 Phillips screwdriver (optional power drill), measuring tape, pencil

Each bracket should be mounted so it is horizontal (with the screws oriented on the left and right sides of the bracket), as shown in **Fig. 2**. Also, if the brackets are mounted around the side of a doorway (**Fig. 1-E**), the opening of the brackets must face away from the gate.

If the gate is mounted into hardwood or metal wall studs, predrilled 3/32 inch (or smaller) pilot holes will be required for mounting the wall brackets.

If the gate is mounted over a baseboard, a wall spacer (equal to the baseboard thickness) is required under the upper wall bracket so the brackets are equally spaced from the wall. Wall Spacer Sets may be purchased from our web site.

NOTE: Retract-A-Gate 72 is designed to accommodate openings up to 72 inches. When mounting the brackets around the side of a doorway on the wall (**Fig. 1-E**), this may require the gate to open beyond its maximum. In this scenario, the brackets must be mounted within the door jam for a maximum opening of 72 inches.

- a) Mount the first bracket so the **bottom** of the bracket is between 3-4 inches off the floor, and **level*** with the floor. Make sure the screws penetrate a minimum of one inch of solid wood or wall stud and are positioned in the washer as shown in **Fig. 3**. **Do not over tighten the screws**; they should be snug and slightly recessed in the washer.

* To help level the brackets, measure and make two marks at the desired height and draw a line. Align the bottom of the bracket to this line.



- b) Mount the second bracket directly above the first, so the **bottom** of the bracket is 30½ inches off the floor.
- c) Repeat steps a) and b) for the other two brackets. Make sure the top and bottom brackets are equal distance apart (**Fig. 1-F and see NOTE below**).

NOTE: As an aid to the fourth bracket placement, install the gate on the first two brackets, pull and hook onto the third bracket. While holding the fourth bracket to verify that the mesh is tight top and bottom, mark the location of the bracket and mount in this location.

2. Installing Retract-A-Gate

Attach the gate to **either** side of the doorway by **fully snapping the gate in place** into both brackets, keeping the base of the gate against the floor. That's all there is, it's that simple!

C. How to Operate

1. Push and turn the knob on the top of the gate to the unlocked position.
2. Using the handle slot provided (**Fig. 1-D**), pull the fabric across the opening and hook the handle rod into the top and bottom brackets using a slow and smooth motion for best results. Use your right hand to operate when pulling to the left or your left hand when pulling to the right.
3. Push and turn the knob to the **Locked** position to secure the fabric.

The gate is now ready for use. To release or retract the gate, reverse these steps by unlocking the knob to allow the gate to retract. **For safety, the gate should always be Locked either in the extended or retracted position.** For proper use, always keep the fabric within the fabric stops and the base of the gate against the floor.

D. Maintenance and Considerations

- Retract-A-Gate may be cleaned with mild soap and water as needed.
- When using outdoors, it is recommended to bring the gate indoors when not in use. This will help keep the gate cleaner and prolong its life. Do not leave in freezing temperatures.
- Do not use Retract-A-Gate if any components are damaged or missing.
- Never step over the gate.

E. Warranty

Your Retract-A-Gate is warranted to be free from defects in materials or workmanship for a period of one year from the date of purchase. Contact our Customer Service department for details.

F. Optional Accessories

Please visit our website, **www.Retract-A-Gate.com** for more information on accessories available to enhance the use and installation of your Retract-A-Gate.

G. Troubleshooting

1. If the locking mechanism sticks, a slight back and forth twist to the reel of fabric will free it.
2. If hooking the handle rod into the brackets is difficult, verify the following:
 - a. The brackets are level with the floor
 - b. The horizontal distance between the top and bottom brackets are equal (**Fig. 1-F**)
 - c. The brackets are directly vertical (plumb) of each other on each side of the doorwayFor best results, use a slow and smooth motion to hook the handle rod to the brackets.
3. Visit our Frequently Asked Questions at **www.Retract-A-Gate.com/faq.html**

H. Customer Service

Web site: www.Retract-A-Gate.com email: info@Retract-A-Gate.com Phone: (312) 546-4702
The Creative Frontier, Inc. 624 Spring St. Galena, IL 61036 USA